

GRP CARTRIDGE FILTER VESSELS

Description

The TPRO range of **GRP Cartridge Filter Vessels** has been designed specifically to be utilised in the sea water reverse osmosis desalination industry. The vessels are constructed from glass reinforced polyester (GRP) and incorporate an integral resin rich liner. All wetted components are non-metallic or 6% Mo Stainless steel such as SMO 254 (UNS S31254). In addition, all sealing hardware is manufactured out of stainless steel such as no painted carbon steel or aluminium are utilised in the vessel.

These filters are also suitable and chemically compatible with the chemicals normally utilized in the cleaning of reverse osmosis. TUA Engineering can build vessels capable to accommodate up to 141 X 50" elements.

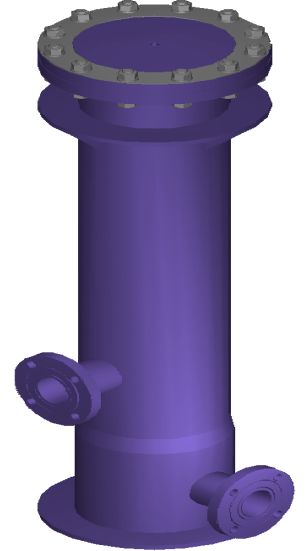

Features

- ⊕ A standard design operating pressure of 6Bar at 21^o C. Higher ratings particularly on the smaller vessels are also available.
- ⊕ Easily removal of cartridge filters on large vessels. This is done by simply lifting out a basket with the entire cartridge filters followed by the insertion of the new pre-loaded basket full of clean cartridge filters.
- ⊕ Standard connections on the larger vessels that include a separate drain capable of handling the vessel's full flow.
- ⊕ Inlet and outlet connection flange orientation can be changed to suit customer's requirements.
- ⊕ A bottom strainer prevents large objects from falling to the bottom of the vessel into the process piping.

Application

The range of the GRP Cartridge Filter Vessels is extensive with the largest capable vessel of 141 X 50" elements. The **TPRO** product range provides a cost effective, durable and a low maintenance solution to your seawater pre-treatment needs.

GRP CARTRIDGE FILTER VESSELS

Models

MODEL	Number of elements	Vessel ID mm	Max. Element length	Max flow 40" elements m ³ /hr	Max flow 50" elements m ³ /hr
TPRO140	101 – 141	1090	50"	560	700
TPRO100	61 – 100	930	50"	400	500
TPRO080	60 – 80	800	50"	320	400
TPRO060	40 – 58	600	50"	230	280
TPRO028	19 – 28	500	50"	110	140

Note:

Other sizes are available upon request. For further information contact TUA Engineering Ltd.

